

Case Study

PROJECT NAME: CAWDERCULT FARM

PROJECT TYPE: BAT SURVEY PROGRAMME

CLIENT: CKD GALBRAITH

DATE: OCTOBER 2014

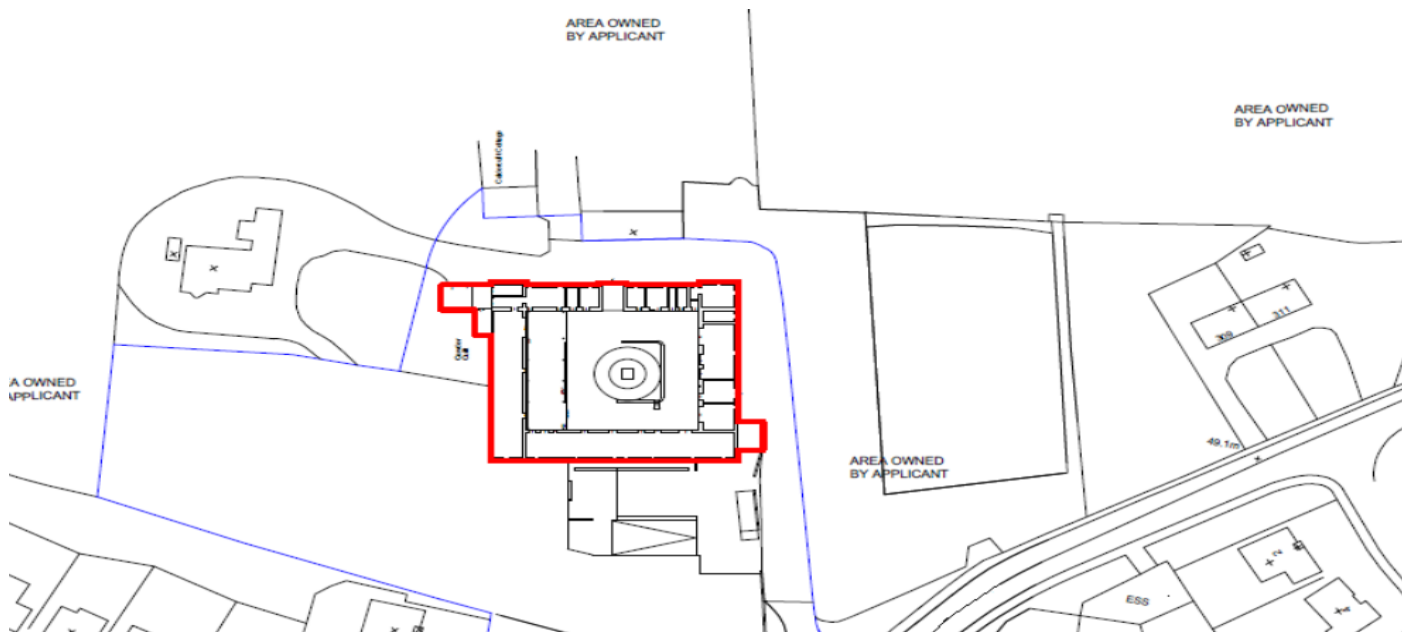

Neo Environmental were commissioned by CKD Galbraith to undertake activity surveys for a derelict farm complex to identify bat roosts. The client intended on carrying out remedial works on the existing building to make it safe whilst options for re-development were considered.

Neo Environmental's involvement:

Undertake a bat survey programme for the farm complex, comprising of three activity surveys and remote automated detector surveys, to ascertain whether bat roosts were present within the buildings.

Project Outcomes:

- From the initial building assessment it was ascertained that the buildings had high bat roosting potential.
- Small numbers of bats were found to be foraging and commuting within the area, though no bats were found to be associated with the buildings and no evidence of roosting bats was established.
- All work was carried out in a timely, cost-effective manner, adhering to current standard guidance to prevent any un-necessary delays to the client.